

# WESTFIELD WASHINGTON PUBLIC LIBRARY

Westfield, Indiana

Architect: krM Architecture Contractor: Spohn Associates

VUE™ with Glass • Post Mounted Handrail • Structural Glass



The new **Westfield Washington Public Library** features a transformative railing system designed and installed through a collaboration between krM Architecture and Spohn Associates, both of Indianapolis, and Hollaender Manufacturing Co. of Cincinnati, Ohio.

Central to the design are varied railing systems throughout the facility. The standout feature, the Grand Stair and adjacent Learning Stair, showcases Hollaender's **VUE™ post-mounted glass railing system** with a black anodized aluminum finish, paired with a single-line ADA accessible, clear anodized aluminum assist rail.



Hollaender also supplied structural glass railing systems for the interior overlook and outdoor patio. The use of anodized aluminum and glass railings creates an open, airy atmosphere while delivering safety, aesthetics, and cost-effectiveness, maximizing value for the community.

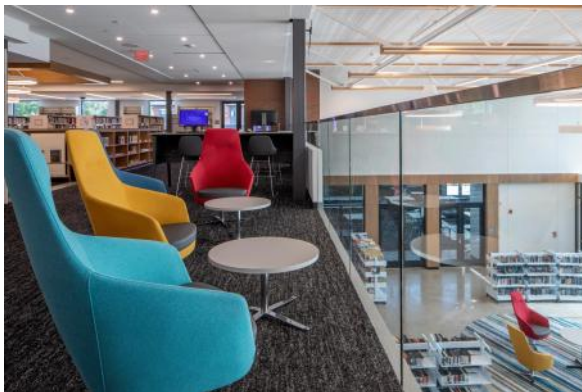

Library Executive Director Sheryl Sollars articulated the vision:

“This state-of-the-art building will anchor Westfield’s growing downtown, serving as a welcoming hub where all are encouraged to explore, discover, and grow.”